

Delegated Decision

13 March 2019



**Granting Of A Section 50 Licence To
Install A Private Sewer Connection In
Unclassified Damson Way, Dragonville
Industrial Estate, County Durham**

Ordinary Decision/Key Decision No.

Report of Network Management

Brian Buckley, Strategic Highways Manager

Electoral division(s) affected:

Belmont

Purpose of the Report

- 1 To seek approval to grant a licence in accordance with Section 50 of the New Roads and Street Works Act 1991 (NRSWA) to enable Londonmetric Retail Ltd to install a private drainage connection within the adopted highway.

Executive summary

- 2 An application to install a private drainage connection in Unclassified Damson Way, Dragonville Industrial Estate, County Durham has been submitted by Londonmetric Retail Ltd, 1 Curzon Street, London, W1J 5HB.

Recommendation

- 3 In line with legislation allowing the installation of apparatus in the highway I suggest the application be permitted in accordance with current practice and procedure.

Background

- 4 It is illegal to dig up the adopted highway without consent of the Highway Authority (Highways Act 1980 Section 131). The installation of apparatus within the highway is permissible under Section 50 of the New Roads and Street Works Act 1991 upon request / consent of the Highway Authority.

Details of any alternative options considered and rejected when making the decision

- 5 As the works are not being undertaken by a statutory undertaker, there is no alternative other than to consider the apparatus as private, until such times as the connections are adopted by a statutory undertaker. Therefore, a licence under Section 50 of the New Roads and Street Works Act is required to authorise and control the proposed works.

Main implications

Legal Implications

- 6 A standard S50 Licence is to be signed by both parties and sealed. Details of the agreement are to be registered with the land registry, as appropriate. The Highway Authority is to record the agreement and inform the utility companies accordingly upon request about private apparatus in the highway

Finance Implications

- 7 A licence fee of £796 has been paid. This licence fee incorporates administration, inspection, registration and legal fees. A cash bond of £1,410 has also been obtained to cover the reinstatements to be completed

Conclusion

- 8 Decision to grant a licence in line with Section 50 of the New Roads and Street Works Act 1991. This section of the Act permits the installation of apparatus in the highway in line with the terms and conditions imposed by the Highway Authority for County Durham.

Contact: Victoria Erskine

Tel: 03000 267 102

Brian Buckley

Tel: 03000 268 079

Appendix 1: Implications

Legal Implications

A standard S50 Licence is to be signed by both parties and sealed. Details of the agreement are to be registered with the land registry, as appropriate. The Highway Authority is to record the agreement and inform the utility companies accordingly upon request about private apparatus in the highway.

Finance

A licence fee of £796 has been paid. This licence fee incorporates administration, inspection, registration and legal fees. A cash bond of £1,410 has also been obtained to cover the reinstatements to be completed.

Consultation

Consultations have been completed with relevant Durham County Council staff

Equality and Diversity / Public Sector Equality Duty

Not applicable

Human Rights

Not applicable

Crime and Disorder

Not applicable

Staffing

Not applicable

Accommodation

Not applicable

Risk

Not applicable

Procurement

Not applicable

DO NOT SCALE

NOTES

NOTES

- ALL MANHOLE COVER LEVELS ARE APPROXIMATE AND SHOULD BE ADJUSTED TO SUIT THE ARCHITECTS FINISHED LEVEL SCHEME.
- FOR LONG SECTION AND SECTION DETAIL REFER TO JPG DRAWINGS 4826-D8

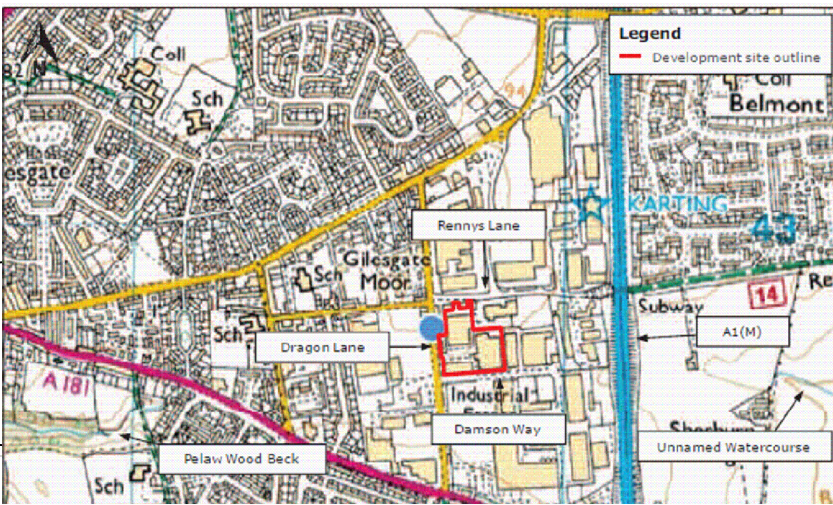

SITE LOCATION PLAN

ORDNANCE SURVEY NATIONAL GRID
REFERENCE NZ 297 427

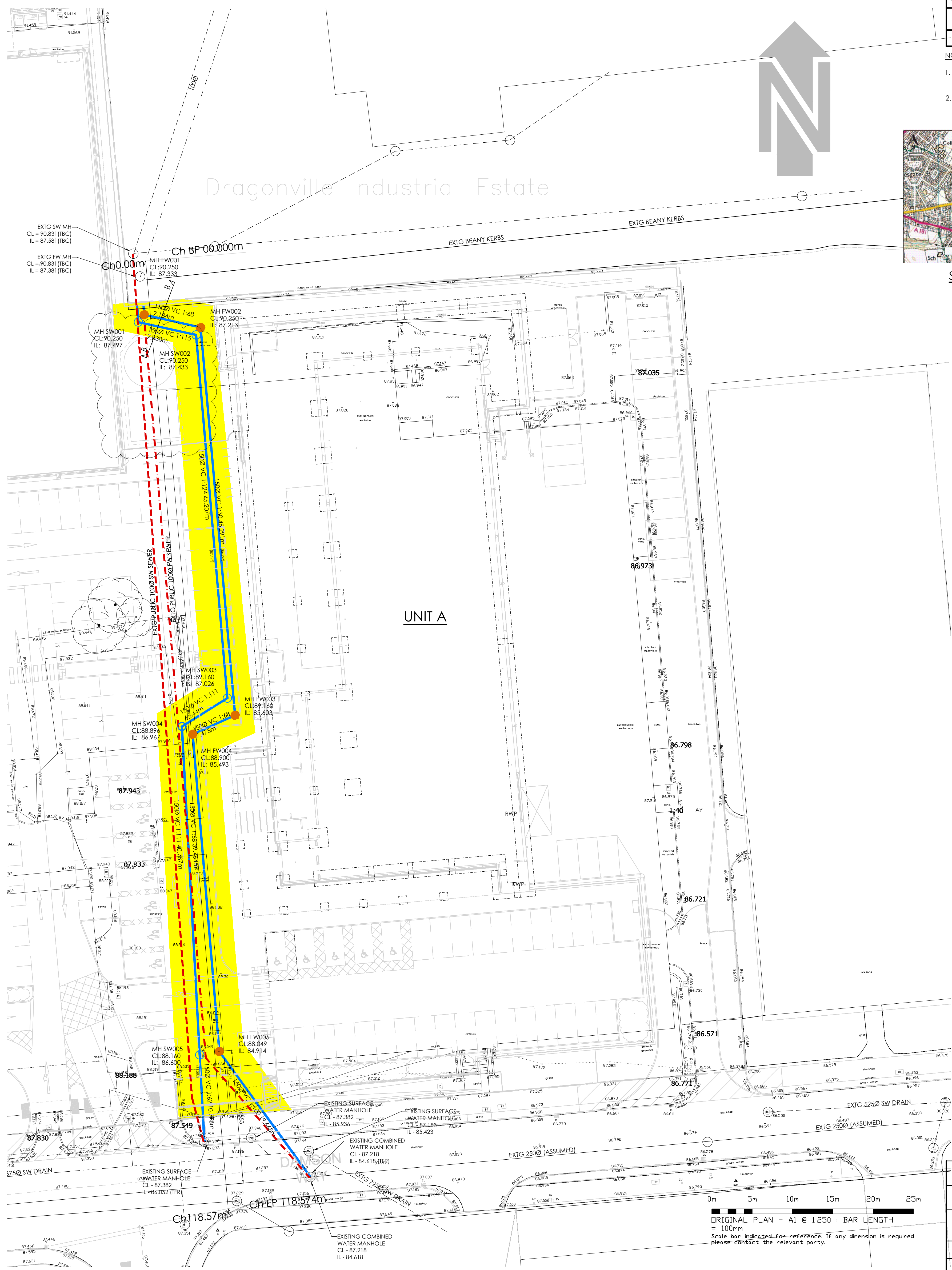

ALL EXISTING SEWER INVERT LEVELS TO BE CHECKED ON SITE PRIOR TO COMMENCEMENT OF SEWER DIVERSION WORKS AND REPORTED TO ENGINEER

ALL ABANDONMENTS MUST BE WITNESSED FOR THE STATUS OF THE PIPE TO BE CHANGED ON THE PUBLIC SEWER RECORDS

| | | | |
|-----|---|----------|-----|
| E | PLAN REVISED TO INDICATE LATEST SPRINKLER TANK AND PUMP HOUSE LOCATION | 23.01.19 | RJW |
| D | NOTES ADDED AS CLOUDED AND SECTION MARK ADDED AS REQUESTED BY NWL | 04.12.18 | RJW |
| C | NOTE REGARDING ADDITIONAL PROTECTION OMITTED AND FOUL DRAIN COLOURED BLUE AS PER NWL COMMENTS | 23.11.18 | RJW |
| B | ADOPTABLE DRAIN LOCATION REVISED TO SUIT NWL COMMENTS | 09.11.18 | RJW |
| A | DRAIN LOCATIONS UPDATED TO SUIT GMI COMMENTS | 17.10.18 | RJW |
| REV | DESCRIPTION | DATE | BY |

Job Title
DRAGON LANE
DURHAM

Drawing Title
S185 SEWER DIVERSION PLAN

PRELIMINARY

Architect
THE HARRIS PARTNERSHIP



Leeds: 0113 263 1155 | London: 020 7947 4148

| | | | | |
|---------------|------------------|----------------|----|--------------|
| Checked KH | Date MAR 2018 | Scale 1:250 | A1 | Drawn RJW |
| Drawing No | 4826-D7 | E | | |

SURFACE WATER SEWER DIVERSION MANHOLES

| NAME | COVER | INVERT | PIPEDIA | Diameter | DUTY | STATUS | Position X | Position Y | DEPTH TO SOFFIT | DEPTH TO INVERT | ADOPTABLE |
|----------|--------|--------|---------|----------|------|--------|-------------|-------------|-----------------|-----------------|-----------|
| MH SW001 | 90.250 | 87.497 | 150 | 1050.0 | D400 | NEW | 429786322.5 | 542754727.1 | 2.603 | 2.753 | YES |
| MH SW002 | 90.250 | 87.433 | 150 | 1050.0 | D400 | NEW | 429793485.5 | 542753132.3 | 2.667 | 2.817 | YES |
| MH SW003 | 89.160 | 87.026 | 150 | 1050.0 | D400 | NEW | 429797361.2 | 542708091.7 | 1.984 | 2.134 | YES |
| MH SW004 | 88.896 | 86.967 | 150 | 1050.0 | D400 | NEW | 429791726.0 | 542704571.3 | 1.779 | 1.929 | YES |
| MH SW005 | 88.160 | 86.600 | 150 | 1050.0 | D400 | NEW | 429793932.9 | 542663843.9 | 1.410 | 1.560 | YES |

FOUL WATER SEWER DIVERSION MANHOLES

| NAME | COVER | INVERT | PIPEDIA | Diameter | DUTY | STATUS | Position X | Position Y | DEPTH TO SOFFIT | DEPTH TO INVERT | ADOPTABLE |
|----------|--------|--------|---------|----------|------|--------|-------------|-------------|-----------------|-----------------|-----------|
| MH FW001 | 90.250 | 87.333 | 150 | 1050.0 | D400 | NEW | 429787044.9 | 542755646.7 | 2.767 | 2.917 | YES |
| MH FW002 | 90.250 | 87.213 | 150 | 1050.0 | D400 | NEW | 429794049.8 | 542754052.1 | 2.887 | 3.037 | YES |
| MH FW003 | 89.160 | 85.603 | 150 | 1050.0 | D400 | NEW | 429798315.6 | 542705969.3 | 3.407 | 3.557 | YES |
| MH FW004 | 88.900 | 85.493 | 150 | 1050.0 | D400 | NEW | 429793069.8 | 542703613.0 | 3.257 | 3.407 | YES |
| MH FW005 | 88.049 | 84.914 | 150 | 1050.0 | D400 | NEW | 429796364.9 | 542664272.6 | 2.985 | 3.135 | YES |

KEY:

- FOUL WATER PROPOSED ADOPTABLE
- SURFACE WATER PROPOSED ADOPTABLE
- EXISTING SURFACE WATER DRAIN
- EXISTING FOUL DRAIN
- EXISTING COMBINED WATER DRAIN
- PROPOSED FOUL MANHOLE
- PROPOSED SURFACE WATER MANHOLE
- SITE BOUNDARY
- EXISTING LEVELS
- PROPOSED LEVELS
- EASEMENT

DRAINAGE LAYOUT KEY

KEY:

- PROPOSED FOUL DRAIN
- PROPOSED SURFACE WATER DRAIN
- - - EXISTING SURFACE WATER DRAIN
- - - EXISTING FOUL DRAIN
- - - EXISTING COMBINED WATER DRAIN
- FW PROPOSED FOUL MANHOLE
- SW PROPOSED SURFACE WATER MANHOLE
- FW PROPOSED FOUL WATER PHIC
- G PROPOSED ROAD GULLY
- RWP PROPOSED RAINWATER PIPE
- RE PROPOSED RODDING EYE
- OB PROPOSED ACO OFFFALL BOX
- VP PROPOSED VENT PIPE
- AP PROPOSED ACO ACCESS POINT

DRAINAGE LAYOUT KEY

CELLULAR ATTENUATION TANK
SIZE = 26.0m x 43.5m x 1.5m dp (95% VOIDS)
43.0m WIDTH ALLOWS FOR 1.5m DISTRIBUTION TRENCH THROUGH TANK
CL = 88.122 - 88.475
SL = 87.019 - 87.071
IL = 86.019 - 86.071
TANK PROVIDED WITH FULLY SEALED/WELDED LINER.

| INTERCEPTORS: | |
|-----------------|---------------------|
| INTERCEPTOR No. | CATCHMENT AREA (m2) |
| ① | 700 |
| ② | 5630 |
| ③ | 3550 |

NOTES

ALL INTERCEPTORS TO HAVE 50mm STEP ACROSS INVERT & TO BE CLASS 1. INTERCEPTOR No.1,2 & 3 IS A TYPE 1 BYPASS SEPARATOR. INTERCEPTORS TO BE PROVIDED WITH AN OIL LEVEL MONITOR & ALARM. CONTRACTOR TO PROVIDE ELECTRIC SUPPLY TO MONITOR. INTERCEPTOR SUPPLIER MUST BE ON THE ENVIRONMENT AGENCY'S APPROVED LIST OF COMPLIANT MANUFACTURERS IN ACCORDANCE WITH THE CONSTRUCTION PRODUCTS REGULATIONS 1991 AND PPWS.

INTERCEPTOR 1 ALARM TO BE LOCATED WITHIN THE RANGE. INTERCEPTOR 2 & 3 ALARMS TO BE LOCATED WITHIN LIDL STORE. ROUTES TO BE CONFIRMED BY THE M&E DESIGNER

INTERCEPTOR TABLE

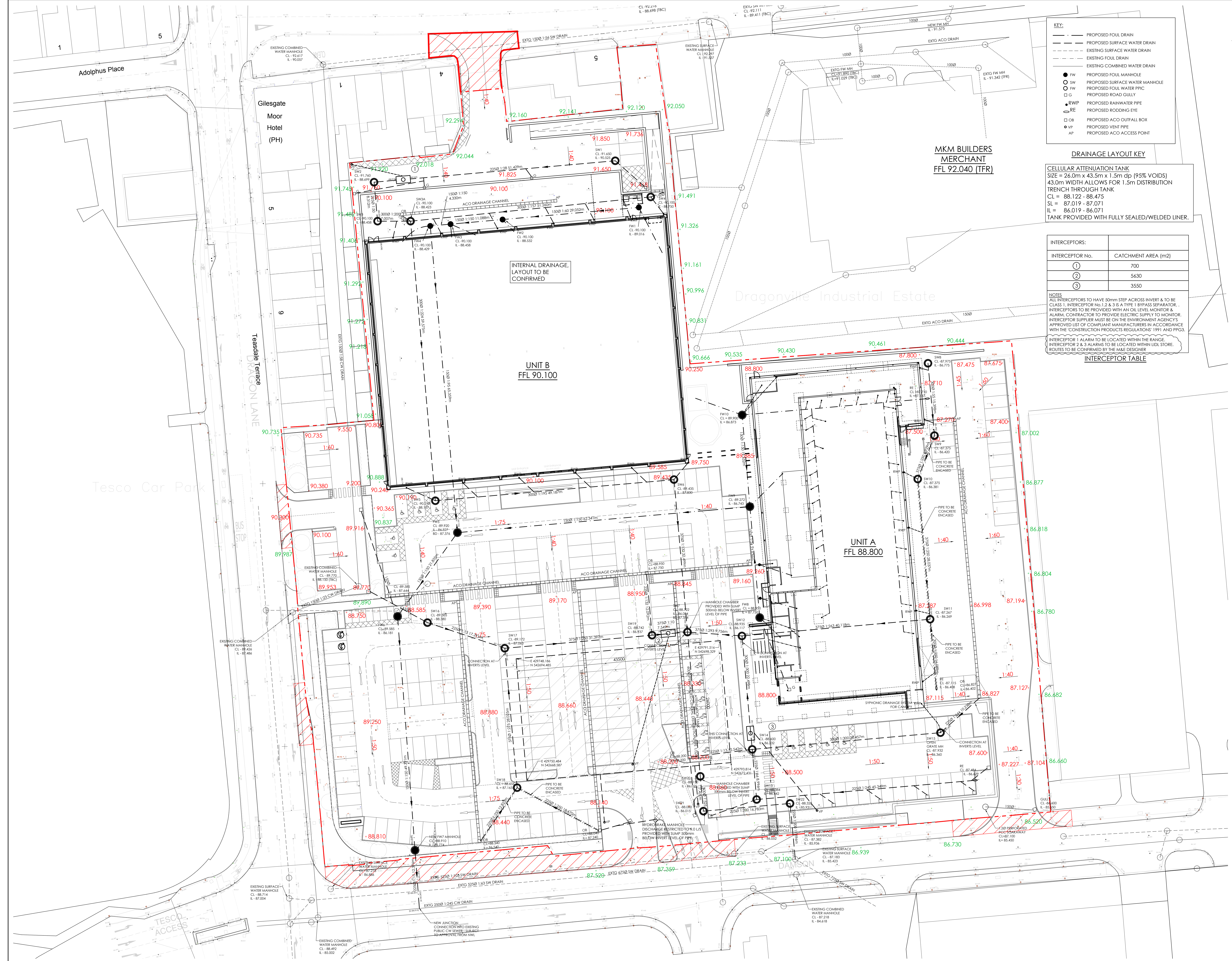

| H | ATTENUATION SETTING OUT ADDED | 21.01.19 | BT |
|-----|---|----------|-----|
| G | ACO SYSTEM UPDATE, INTERCEPTOR VENTS ADDED AND ALARMA LOCATIONS NOTED | 17.01.19 | BT |
| F | NEW RANGE POP UP ADDED & GATIC LAYOUT INCORPORATED | 05.12.18 | BT |
| E | DRAINAGE LEVELS REVERSED IN LIDL OF CONTRACTOR COMMENTS | 27.11.18 | BT |
| D | DRAINAGE TO REAR OF RANGE STORE REVERSED TO AVOID CLASHES | 22.11.18 | BT |
| C | PLAN UPDATED TO INCLUDE LATEST ARCHITECTS PLAN | 19.11.18 | BT |
| B | PW PUMP STATION OMITTED, NEW FW CUTFALL CONNECTION AT DAWSON WAY | 02.10.18 | RJW |
| A | ATTENUATION TANK SIZE REVERSED TO SUIT F&L DISCHARGE RATE | 17.05.18 | RJW |
| REV | DESCRIPTION | DATE | BY |



Job Title
**DRAGON LANE
DURHAM**

Drawing Title
DRAINAGE LAYOUT

CONSTRUCTION

Architect
THE HARRIS PARTNERSHIP

JPG
www.jpg-group
Leeds: 0113 263 1155 | London: 020 7947 4148

| | | | | |
|----------------|------------------|----------------|---------|--------------|
| Checked AMF | Date MAR 2018 | Scale 1:250 | A0 | Drawn RJW |
| Drawing No | | | 4826-D1 | |
| | | | H | |